





A beautifully presented, significantly improved DETACHED BUNGALOW enjoying a desirable cul-de-sac location in Woodham.

An internal viewing will reveal a spacious living/dining room providing a welcoming atmosphere, perfect for entertaining or relaxing with loved ones. The modern fitted kitchen/breakfast room, and a convenient utility room, ensures that daily tasks are a breeze.

The principal bedroom overlooks the rear garden and is equipped with built-in wardrobes and an en-suite shower room/WC. The family bathroom features a separate corner shower cubicle, adding to the practicality of this delightful home.

Set on a generous corner plot, the property boasts beautifully landscaped side and rear gardens, providing a serene outdoor space for gardening enthusiasts or those who simply wish to enjoy the fresh air. The extensive driveway offers ample parking for a number of vehicles, complemented by an integrated double garage and gated access to the side of the property providing secure parking, ensuring convenience and peace of mind.

This bungalow is not just a home; it is a lifestyle choice, offering a harmonious blend of space, style, and security in a sought-after location. Whether you are looking to downsize or seeking a family home, this property is sure to impress. Do not miss the opportunity to make this charming bungalow your own.







### **Agents Notes**

Tenure:- Freehold

Mains gas, (central heating to radiators), electricity & drainage

uPVC double glazing throughout

Council Tax:- Band E

Local Authority:- Durham County Council

## Ground Floor

Approx. 156.0 sq. metres (1679.7 sq. feet)

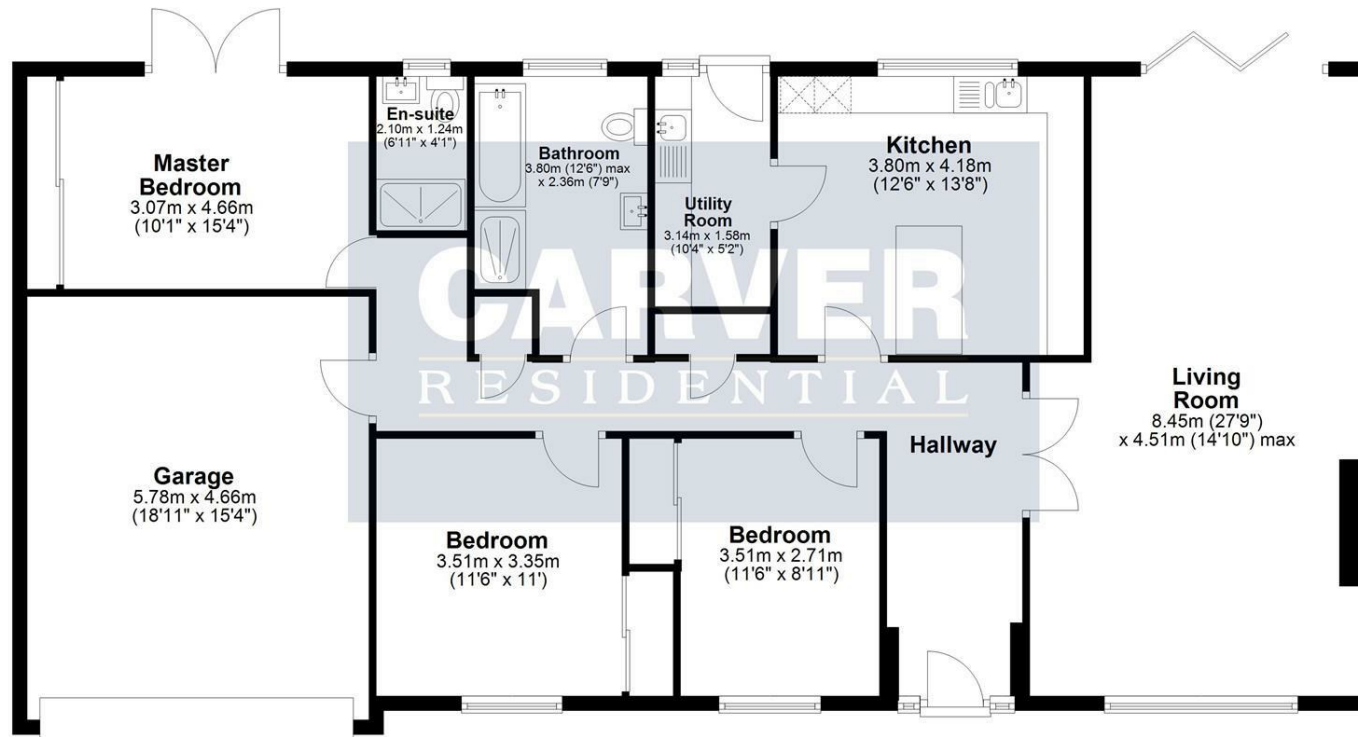

Energy Efficiency Rating		
	Current	Potential
Very energy efficient - lower running costs		
(92 plus) <b>A</b>		82
(81-91) <b>B</b>		
(69-80) <b>C</b>		
(55-68) <b>D</b>		
(39-54) <b>E</b>		
(21-38) <b>F</b>		
(1-20) <b>G</b>		
Not energy efficient - higher running costs		
	72	
England & Wales		EU Directive 2002/91/EC

Total area: approx. 156.0 sq. metres (1679.7 sq. feet)

**6 Low Green, Newton Aycliffe**

**We can search 1,000s of mortgages for you**

It could take just 15 minutes with one of our specialist advisers:  
Call: 01325 380088. Visit: Any of our Offices. Online: [www.mortgageadvicebureau.com/carver](http://www.mortgageadvicebureau.com/carver)



Your home may be repossessed if you do not keep up repayments on your mortgage.  
There will be a fee for mortgage advice. The actual amount you pay will depend upon your circumstances.  
The fee is up to 1% but a typical fee is 0.3% of the amount borrowed

MAB 6202



These particulars do not constitute any part of an offer or contract. None of the statements contained in these particulars are to be relied on as statements or representations of fact and any intending purchaser must satisfy himself by inspection or otherwise to the correctness of each of the statements contained in these particulars. The vendor does not make or give, and neither Nick & Gordon Carver Residential or Commercial, Nick & Gordon Carver, nor any person in their employment has any authority to make or give any representation or warranty whatever in relation to this property



**14 Duke Street, Darlington**  
Co Durham, DL3 7AA  
01325 357807  
[sales@carvergroup.co.uk](mailto:sales@carvergroup.co.uk)

**63 Dalton Way, Newton Aycliffe**  
Co Durham DL5 4NB  
01325 320676  
[aycliffe@carvergroup.co.uk](mailto:aycliffe@carvergroup.co.uk)

**41 Market Place, Richmond**  
North Yorkshire, DL10 4QL  
01748 825317  
[richmond@carvergroup.co.uk](mailto:richmond@carvergroup.co.uk)

**219 High Street, Northallerton**  
North Yorkshire DL7 8LW  
01609 777710  
[northallerton@carvergroup.co.uk](mailto:northallerton@carvergroup.co.uk)

[www.carvergroup.co.uk](http://www.carvergroup.co.uk)